

# TYPICAL INSTALLATION INSTRUCTIONS FOR VINYL NEW CONSTRUCTION PATIO DOORS

## FAILURE TO FOLLOW THESE INSTALLATION INSTRUCTIONS VOIDS MANUFACTURER'S WARRANTY.

- 1) APPLY GENEROUS BEAD OF CAULK ALONG INTERIOR SURFACE OF NAILING FIN ON ALL SIDES PRIOR TO SETTING INTO OPENING. IF SILL FIN IS REMOVED, APPLY GENEROUS BEAD OF CAULK TO SLAB BEFORE SETTING DOOR INTO OPENING.
- 2) THROUGHOUT INSTALLATION, KEEP THE DOOR JAMBS PLUMB AND SQUARE. KEEP HEAD AND SILL LEVEL AND SQUARE. MAKE SURE HEAD AND SILL ARE NOT CROWNED UP OR DOWN.
- 3) CONSTANTLY CHECK WIDTH TO AVOID "BOWED OUT" INSTALLATION.
- 4) PLACE SHIMS AROUND DOOR TO CENTER THE DOOR IN THE OPENING. ALLOW A 1/4" GAP BETWEEN DOOR AND FRAMING ON EACH SIDE. WHEN INSTALLATION IS COMPLETE, THESE SHIMS MAY BE REMOVED. FOR ANY INSTALLATION FINISHED WITH BRICK OR STONE, ALLOW 1/4" GAP BETWEEN SILL OF DOOR AND STRUCTURE. CAULK THIS GAP AFTER COMPLETING INSTALLATION.
- 5) INSTALL FASTENERS (STRAIGHT, NOT ANGLED) IN EVERY OTHER FASTENER SLOT STARTING AT THE MIDDLE OF DOOR. FASTENER MUST BE IMBEDDED INTO SOLID WOOD A MINIMUM OF 1".
- 6) CAULK OVER FASTENERS AND ANY FASTENER SLOTS NOT USED.
- 7) CAULK OUTSIDE PERIMETER OF INSTALLED DOOR.
- 8) INSULATE BETWEEN DOOR AND FRAMING WITH BATT TYPE INSULATION. DO NOT USE EXPANDABLE FOAM. THE USE OF EXPANDABLE FOAM WILL VOID WARRANTY.
- 9) CAULK GAP BETWEEN INSTALLED DOOR EXTERIOR PERIMETER AND J-CHANNEL (OR BRICK OR OTHER EXTERIOR FINISHING MATERIAL).
- 10) AFTER INSTALLATION IS COMPLETED, MAKE SURE THE ANTI-LIFT BRACKETS ARE LOCATED ABOVE THE ROLL PANEL WHEN IN CLOSED POSITION.

## 910 PATIO DOOR OPERATION REVERSING INSTRUCTIONS

### ***OPERATION REVERSAL MUST BE DONE BEFORE DOOR INSTALLATION.***

- 1) REMOVE OPERATING PANEL: ROLL PANEL PAST THE ANTI-LIFT BRACKETS (LOCATED IN THE HEAD OF THE DOOR). LIFT PANEL UPWARD AND ROTATE BOTTOM OF PANEL INWARD. IT MAY BE NECESSARY TO ADJUST THE PANEL ROLLERS SO THAT THEY ARE UP IN THE PANEL AS FAR AS THEY WILL GO
- 2) REMOVE ROLLER TRACKS FROM SILL. REMOVE ANTI-LIFT BRACKETS AND PANEL BUMPER FROM HEAD. (IF NECESSARY, USE A PLIERS TO PULL TRACKS OR SCREWDRIVER TO LIFT/PRY TRACKS OUT OF FRAME.)
- 3) ROTATE (CART WHEEL) MAIN FRAME 180° (SO THAT HEAD IS NOW WHERE THE SILL ORIGINALLY WAS AND VICE VERSA) AND RE-INSTALL ROLLER TRACKS, ANTI-LIFT BRACKETS, AND PANEL BUMPER.
- 4) REMOVE ROLLERS FROM "BOTTOM" OF OPERATING PANEL AND INSTALL INTO "TOP" OF PANEL.
- 5) ROTATE (CARTWHEEL) MOVING PANEL 180°, THE SAME WAY AS THE MAIN FRAME IN STEP #3.
- 6) RE-INSTALL MOVING PANEL INTO MAIN FRAME: LIFT PANEL UPWARD INTO HEAD TRACK AND ROTATE BOTTOM OF PANEL INTO SILL TRACK.
- 7) ADJUST ROLLERS AS NECESSARY.
- 8) REMOVE MORTISED LOCK ASSEMBLY FROM MOVING PANEL. FLIP LOCK ASSEMBLY UPSIDE DOWN AND RE-INSERT IN PANEL.
- 9) INSTALL HANDLE SET ACCORDING TO THE INSTRUCTIONS PROVIDED WITH THE HANDLE SET.

#### **IMPORTANT:**

- IT IS THE RESPONSIBILITY OF THE OWNER, ARCHITECT, OR BUILDER TO SELECT FENESTRATION PRODUCTS IN COMPLIANCE WITH APPLICABLE LAWS AND BUILDING CODES.
- DO NOT LAY DOORS FLAT OR STORE IN SUNLIGHT BEFORE INSTALLING.
- ALL WARRANTIES NULL AND VOID IF ANY HOLES ARE PUT IN THE SILL AREA OF ANY M.I. OR CAPITOL PRODUCT.

CAUTION: SOME LAWS AND BUILDING CODES REQUIRE SAFETY GLASS BE USED NEAR DOORS AND FLOORING. UNLESS SPECIFICALLY ORDERED, THE MANUFACTURERS' NEW CONSTRUCTION WINDOWS ARE NOT MADE WITH SAFETY GLASS, AND, IF BROKEN, THE GLASS MAY SHATTER.

INST-189



# 910 SERIES PATIO DOOR MULLING INSTRUCTIONS

## STEP 1

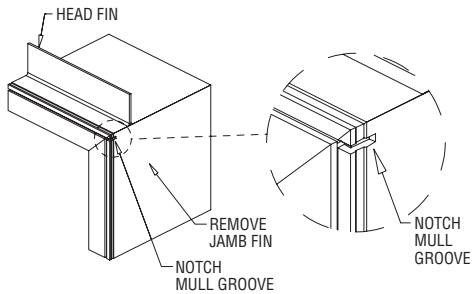

REMOVE NAILING FIN FROM THE JAMBS BEING MULLED TOGETHER. NOTCH MULLION GROOVE FOR THE DRIP CAP. IF APPLICABLE, REMOVE THE J-CHANNEL AS WELL.

## STEP 2

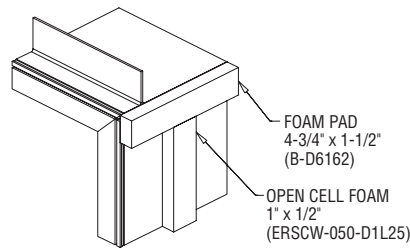

APPLY ONE FOAM PAD (HORIZONTALLY) AT THE TOP AND BOTTOM, AS SHOWN.  
 -APPLY PADS TO ONE FRAME ONLY. APPLY FULL LENGTH OPEN CELL FOAM (VERTICALLY) BETWEEN FOAM PADS.  
 -APPLY FOAM TO ONE FRAME ONLY.

## STEP 3

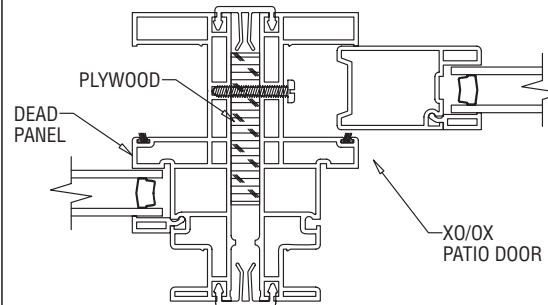

### OXO SETUP ONLY

OXO SETUPS ARE REQUIRED TO HAVE A PIECE OF PLYWOOD (MEASURING 1/2" X 2-1/2" X 12") INSERTED BETWEEN THE XO PATIO DOOR AND DEAD PANEL IN THE PROXIMITY OF THE KEEPER SCREW TO PROVIDE ADDITIONAL SUPPORT IN-BETWEEN THE MAIN FRAME JAMBS. THE CENTER OF THE PLYWOOD IS LOCATED 40" UP FROM THE MAIN FRAME SILL ON ALL HEIGHTS (6/8, 6/10 & 8/0).

## STEP 4

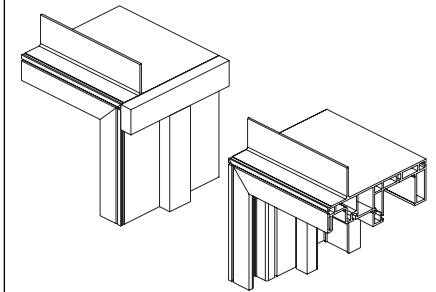

ALIGN THE FRAMES

## STEP 5

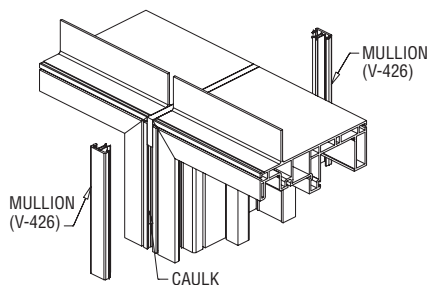

SLIDE FRAMES TOGETHER AND APPLY INSIDE MULLION. APPLY CAULK ALONG JOINT BETWEEN FRAMES AND APPLY OUTSIDE MULLION.

## STEP 6

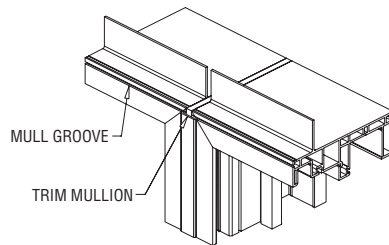

TRIM OUTSIDE MULLION EVEN WITH MULL GROOVE AT THE TOP, TO ALLOW DRIP CAP TO BE INSTALLED, AND EVEN WITH SILL AT THE BOTTOM.

## STEP 7

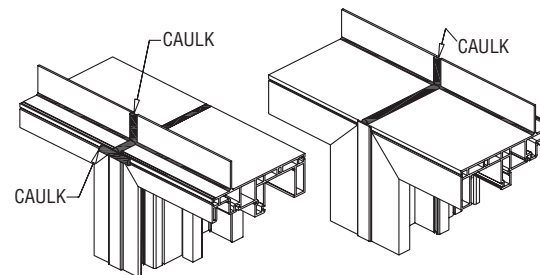

**IMPORTANT:** USE A QUALITY EXTERIOR GRADE SILICONE CAULK. APPLY 1/4" BEAD OF CAULK ACROSS THE HEAD OF BOTH FRAMES, AS SHOWN, BEFORE APPLYING THE DRIP CAP - APPROXIMATELY 1/4" AWAY FROM THE OUTSIDE EDGE OF THE FRAME. APPLY CAULK ACROSS THE ENDS OF THE FRAMES AND UP THE FINNS. BE SURE THE ENTIRE WIDTH OF THE GAP IS COVERED AND THAT CAULK OVERLAPS BOTH FRAMES BY AT LEAST 1/2".

## STEP 8

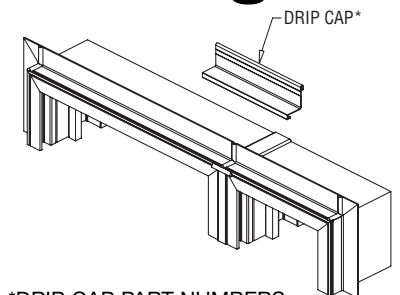

\*DRIP CAP PART NUMBERS:  
 (M-1910) STD 1" FIN SET-BACK  
 (M-2145) OPT 1-3/8" FIN SET-BACK  
 (M-1900) J-CHANNEL FRAME

APPLY A 4" PIECE OF DRIP CAP TO THE HEAD, LOCATED WHERE THE FRAMES ARE MULLED TOGETHER, BY HOOKING THE DRIP CAP ONTO THE NAILING FIN AND ROTATING INTO THE MULLION GROOVE.